

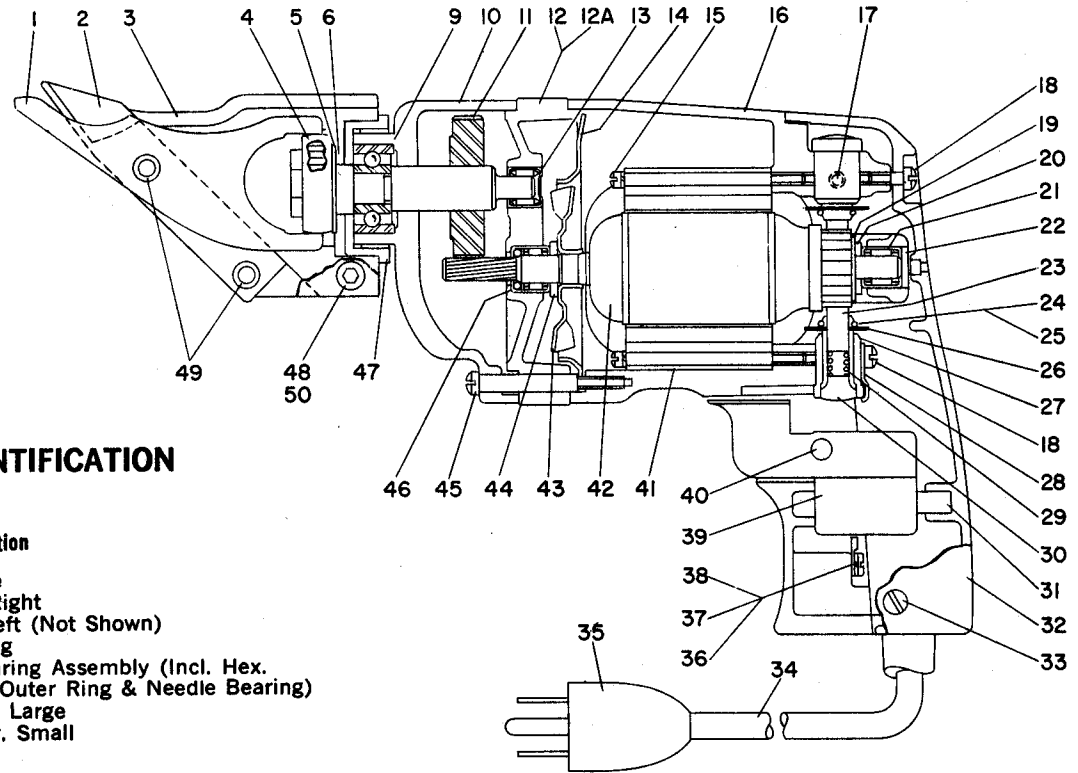

Model B-100 Electric Shear PARTS LIST



PARTS IDENTIFICATION

| Index No. | Part No. | Description |
|-----------|----------|--|
| 1 | 60-21 | Center Blade |
| 2 | 60-22 R | Side Knife, Right |
| | 60-22 L | Side Knife, Left (Not Shown) |
| 3 | 60-23 | Shear Housing |
| 4 | 60-24 | Eccentric Bearing Assembly (Incl. Hex. Eccentric, Outer Ring & Needle Bearing) |
| 5 | 60-25 | Thin Washer, Large |
| 6 | 56280-01 | Thick Washer, Small |
| 9 | 17541 | Ball Bearing |
| 10 | 70591 | Gear Case |
| 11 | 70594 | Spindle & Gear |
| 12 | 52228 | Gear Case Cover Assem. (Incl. Nos. 12A, 13, 46) |
| 12A | 50560 | Gear Case Cover |
| 13 | 20812 | Needle Bearing |
| 14 | 38016 | Fan Baffle Plate |
| 15 | 25999 | #6-32 x 2" Fill. Hd. Scr. & W. (2) |
| 16 | 56377-01 | Field & Switch Case (Also 57035) |
| 17 | 27760 | #8-32 x 1/4" Slotted, Cup Point Set Screw (Torque To 4-7 In. Lbs.) |
| 18 | 2178 | #8-32 x 3/8" Fill. Hd. Scr. (2) |
| 19 | 48601 | Spring Washer |
| 20 | 37414 | Fibre Washer |
| 21 | 50573 | Roller Bearing |
| 22 | 50575 | Bearing Seal |
| 23 | 49940 | Brush (2) |
| 24 | 50182 | Brush Lead Terminal (2) |
| 25 | 50230-01 | Connector (2) |
| 26 | 27766 | Insulating Shield (2) |
| 27 | 55443 | Brush Holder (115V) (2) |
| | 50233 | Brush Holder (220V) (2) |
| 28 | 36542 | Brush Holder Clamp |
| 29 | 50130 | Brush Spring (2) |
| 30 | 49944 | Brush Holder Plug (2) |
| 31 | 30613 | Rubber Plug |
| 32 | 58159-01 | Switch Handle Cover |
| 33 | 21348 | #8-32 x 5/16" Oval Hd. Scr. (2) |
| 34 | 52900-98 | Cord & Plug (#18-3 SJT-7 Ft.) |
| 35 | 36478 | Attachment Plug |
| 36 | 2379 | #8-32 x 5/16" Bind. Hd. Term. Scr. (Grd.) |
| 37 | 418 | #8 Lockwasher |
| 38 | 1747 | Lead Terminal |
| 39 | 57362 | Switch (Also 56924) |
| 40 | 57363 | Switch Button |
| 41 | 57587-71 | Field (115V) (Incl. No. 24 [2], 25 [2]) |
| | 57587-75 | Field (220V) (Incl. No. 24 [2], 25 [2]) |
| | 57587-95 | Field (100V) (Incl. No. 24 [2], 25 [2]) |

| Index No. | Part No. | Description |
|-----------|----------|---|
| 42 | 57642-31 | Armature & Fan (100V-115V) (Incl. No. 43) |
| | 50581-42 | Armature & Fan (220V-240V) (Incl. No. 43) |
| 43 | 27773-01 | Fan |
| 44 | 50584 | Felt Washer |
| 45 | 39544 | #8-32 x 1 1/2" Dowel Scr. |
| 46 | 52483 | Roller Thrust Bearing |
| 47 | 70593 | Gear Case Adaptor |
| 48 | 60-28 | Cap Screw (3) |
| 49 | 60-27 | Spacer Bushing (2) |
| 50 | 60-31 | Knurled Insert (3) |

PARTS NOT SHOWN

| | |
|-------|--|
| 60-29 | Allen Wrench |
| 13358 | #8-32 x 2" Fill. Hd. Scr. (2) (In Gear Case) |
| 56378 | Switch Spring |
| 56926 | Connection Diagram |

WHEN ORDERING REPLACEMENT PARTS BE SURE TO STATE MODEL AND SERIAL NUMBER OF SHEAR AND GIVE PARTS NUMBERS AND DESCRIPTIONS.

*NOTE: The locking device (#57362 Switch Button) has purposely been removed from the power unit for the sake of safety.

INSTRUCTIONS FOR DISASSEMBLY AND ASSEMBLY OF SHEAR HEAD NO. 60-20

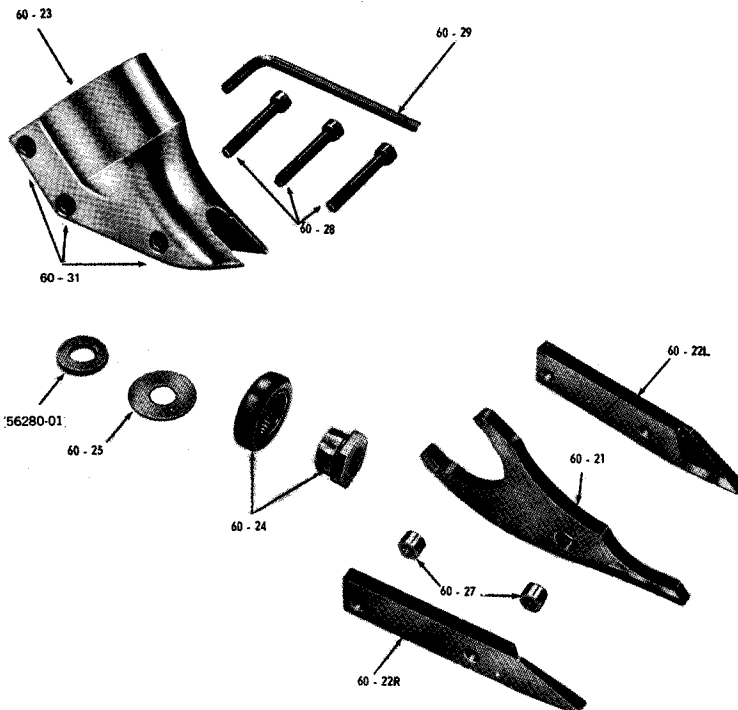

DISASSEMBLY

To remove shear head assembly (60-20) from drive motor:

1. Loosen both rearward cap screws (60-28) three or four complete turns.
2. Remove shear head assembly (60-20) from motor by pulling head firmly forward. Slight twisting action may be required if head does not remove easily.

To remove cutter blades from shear head assembly (60-20):

1. Remove three cap screws (60-28) completely from shear housing (60-23). **Be careful not to lose rear spacer bushing (60-27) when removing rear cap screw.**
2. Remove center blade (60-21) from shear housing (60-23) by tapping blade gently rearward. **Be careful not to lose spacer bushing (60-27) from hole in center blade.**
3. Side knives (60-22L and 60-22R) will now drop out of shear housing.

To remove eccentric bearing assembly (60-24) from shaft:

1. Hold output shaft with wrench to prevent it from turning when removing eccentric nut. Flat areas are provided on the end of the shaft for this purpose.
2. Use an appropriate wrench to loosen eccentric nut by turning counter clockwise.

ASSEMBLY

To install eccentric bearing assembly (60-24) onto shaft:

1. Make sure small thick washer (56280-01) and large thin washer (60-25) are inserted over shaft. Small thick washer (56280-01) must be put on shaft first.
2. Turn eccentric bearing assembly onto shaft and tighten with appropriate wrench. Lubricate bearing with a good grade of bearing grease.

To install cutter blades into shear housing (60-23):

1. Place the left side knife (60-22L) into position in the shear housing (60-23).
2. Insert center cap screw (60-28) through housing and blade just far enough to slip spacer bushing (60-27) over cap screw.
3. Place right side knife (60-22R) into position and push center cap screw through right side knife. Start cap screw into thread just enough to hold blades in place. **DO NOT TIGHTEN.**
4. Insert spacer bushing (60-27) into hole in center blade (60-21) and lubricate with a good grade of bearing grease.
5. Install center blade (60-21) into shear housing (60-23) by tapping blade gently forward using a drift to line up hole in center blade with forward holes in housing.
6. Insert and tighten forward cap screw (60-28) making sure spacer bushing (60-27) in center blade stays in position. Apply good grade of bearing grease to clevis in center blade.
7. Insert rear cap screw (60-28) into shear housing (60-23) but do not completely tighten.

To install shear head assembly (60-20) onto drive motor:

1. Make sure rear cap screw and center cap screw (60-28) are loosened about three or four complete turns.
2. Place shear head onto unit and tighten cap screws (60-28) snugly to lock head assembly in place. It may be necessary to gently tap the shear head assembly into place if it does not readily slip onto the drive motor.

WARNING: THE KETT TOOL CO. CANNOT ASSUME RESPONSIBILITY FOR DAMAGE TO OR MALFUNCTION OF A KETT/WPB SHEAR HEAD USED IN COMBINATION WITH ANY DRILL OTHER THAN THOSE REGULARLY SUPPLIED BY US.

NOTE: WHEN SHEAR HEAD IS PROPERLY ASSEMBLED THE CENTER BLADE WILL MOVE FREELY IN HEAD.