



# Electric Scissor Shears PARTS LIST

## 253-22 Power Unit Parts Identification

Index No.	Part No.	Description
4	60-24	Eccentric Bearing Assembly (Incl. Hex. Eccentric, Outer Ring & Needle Bearing)
5	60-25	Thin Washer, Large
6	56280-01	Thick Washer, Small
9	17541	Ball Bearing
10	70591	Gear Case
11	70594	Spindle & Gear
12	52228	Gear Case Cover Assem. (Incl. Nos. 12A, 13, 46)
12A	50560	Gear Case Cover
13	20812	Needle Bearing
14	38016	Fan Baffle Plate
15	25999	#6-32 x 2" Fill. Hd. Scr. & W. (2)
16	56377-01	Field & Switch Case (Also 57035)
17	27760	#8-32 x 1/4" Slotted, Cup Point Set Screw (Torque To 4-7 In. Lbs.)
18	2178	#8-32 x 3/8" Fill. Hd. Scr. (2)
19	48601	Spring Washer
20	37414	Fibre Washer
21	50573	Roller Bearing
22	50575	Bearing Seal
23	49940	Brush (2)
24	50182	Brush Lead Terminal (2)
25	50230-01	Connector (2)
26	27766	Insulating Shield (2)
27	55443	Brush Holder (115V) (2)
	50233	Brush Holder (220V) (2)
28	36542	Brush Holder Clamp
29	50130	Brush Spring (2)
30	49944	Brush Holder Plug (2)
31	30613	Rubber Plug
32	58159-01	Switch Handle Cover
33	21348	#8-32 x 5/16" Oval Hd. Scr. (2)
34	52900-98	Cord & Plug (#18-3 SJT-7 Ft.)
35	36478	Attachment Plug
36	2379	#8-32 x 5/16" Bind. Hd. Term. Scr. (Grd.)
37	418	#8 Lockwasher
38	1747	Lead Terminal
39	57362	Switch (Also 56924)
40	57363	Switch Button
41	57587-71	Field (115V) (Incl. No. 24 [2], 25 [2])
	57587-75	Field (220V) (Incl. No. 24 [2], 25 [2])
	57587-95	Field (100V) (Incl. No. 24 [2], 25 [2])
42	57642-31	Armature & Fan (100V-115V) (Incl. No. 43)
	50581-42	Armature & Fan (220V-240V) (Incl. No. 43)
43	27773-01	Fan
44	50584	Felt Washer
45	39544	#8-32 x 1 1/2" Dowel Scr.
46	52483	Roller Thrust Bearing
47	70593	Gear Case Adaptor

### PARTS NOT SHOWN

13358	#8-32 x 2" Fill. Hd. Scr. (2) (In Gear Case)
56378	Switch Spring

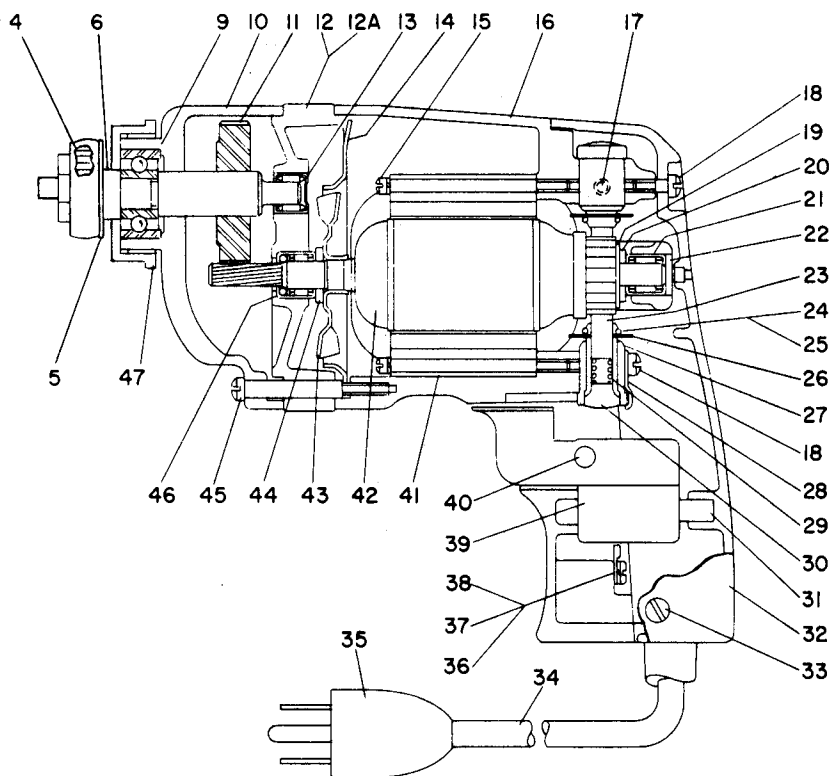

**WARRANTY DOES NOT APPLY IF UNIT IS NOT PROPERLY LUBRICATED**

**Scissor Shear Head**  
(see reverse side of sheet)

### CAUTION:

**KEEP HANDS AWAY FROM THE CUTTING BLADES AT ALL TIMES TO AVOID SERIOUS INJURY.**

Place the material being cut on a clean, clear surface. Make certain there is nothing beneath that could be mistakenly cut. Be certain the power cord is in the clear and free. The locking device has purposely been removed from the power unit for the sake of safety. If by chance a locking device is later installed on the power unit it SHOULD NEVER be locked in the "ON" position.



# Instructions for the Care of the Kett Scissor Shears Head

**CAUTION:**  
Disconnect Power Unit  
Before Servicing Tool

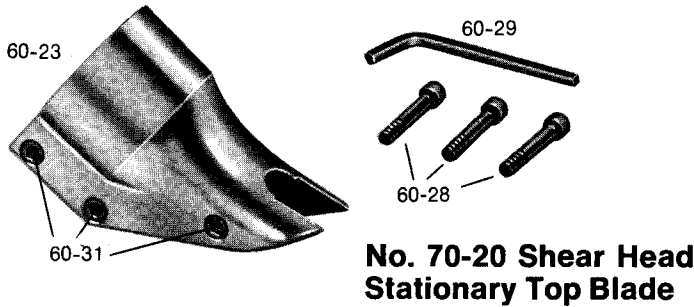

**No. 80-20 Shear Head Stationary Bottom Blade**

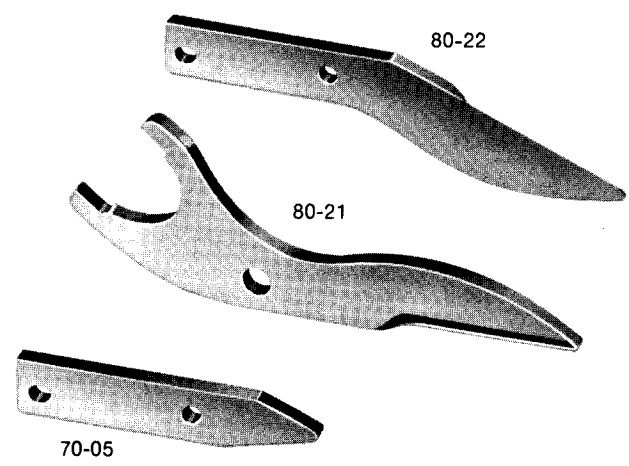
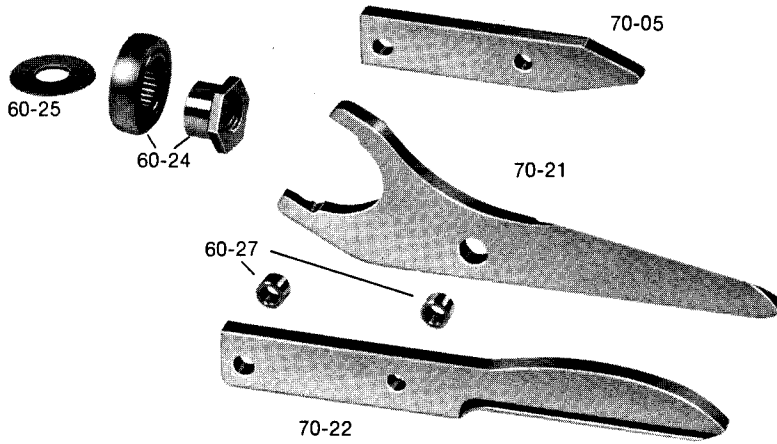

**DISASSEMBLY**

To remove shear head from motor loosen three cap screws (60-28). Remove shear head from motor by pulling head firmly forward. Slight twisting action may be required if head does not slide off easily.

To remove cutter blades from shear head remove three cap screws (60-28) completely from shear housing (60-23). Be careful not to lose rear spacer bushing (60-27) when removing middle cap screw. Remove center scissor blade from shear housing by tapping blade gently rearward. Be careful not to lose spacer bushing (60-27) from hole in center blade. Side knife and side spacer (70-05) will now drop out of the shear housing.

To remove eccentric bearing assembly (60-24) from shaft use an appropriate wrench to loosen eccentric nut by turning counter clockwise.

**ASSEMBLY**

To install eccentric bearing assembly (60-24) onto shaft make sure the large thin washer (60-25) is first inserted over shaft. Screw eccentric bearing assembly onto shaft and tighten with appropriate wrench. Lubricate bearing with a good grade of bearing grease.

To install cutter blades into shear housing (60-23) place the side knife and side spacer into position in the shear housing (60-23). Insert center cap screw (60-28) through side knife and side spacer with rear spacer bushing (60-27) between them and start cap screw into thread just enough to hold blades in place. DO NOT TIGHTEN. Insert spacer bushing (60-27) into hole in center scissor blade and lubricate with a good grade of bearing grease. Install center scissor blade into shear housing by tapping blade gently forward using a drift to line up hole in center blade with forward holes in housing. Insert and tighten forward

60-23	Shear Housing
60-24	Eccentric Bearing Assembly
60-25	Thin Washer, Large
60-27	Spacer Bushing (2)
60-28	Cap Screw (3)
60-29	Allen Wrench
60-31	Knurled Insert (3)
70-05	Side Spacer
70-21	Center Scissor Blade
70-22	Side Knife
80-21	Center Scissor Blade
80-22	Side Knife

cap screw (60-28) making sure spacer bushing (60-27) in center blade stays in position. Apply good grade of bearing grease to clevis or yoke in center blade where it rides on the eccentric bearing assembly. Insert rear cap screw (60-28) into shear housing but do not completely tighten.

To install shear head assembly onto drive motor make sure all cap screws (60-28) are loosened about three or four complete turns. Place shear head onto unit and tighten cap screws snugly to lock head assembly in place. It may be necessary to gently tap the shear head into place if it does not readily slip onto the nose of the power unit.

**SPECIAL SIDE KNIVES**

For cutting woven wood or other rigid slat type materials side knives are available that do not have the wiping action of the standard Scissor Shears. These are: 75-22 Side Knife transforming the 70-20 Shear Head into the 75-20 Shear Head and the 85-22 Side Knife transforming the 80-20 Shear Head into the 85-20 Shear Head.